

Specification Guide Codes:

A= Item Number

B= Insertion & Extraction Force

C= Dielectric Strength For 60 Sec

• Special Design Also Available. For Details Please Contact Factory.

• Use UL Approved Materials • Low Cost • Low Contact Resistance • Flame Retardant.

D= Suitable Rated Current

E= Insulation Resistance At500VDC

F= Temperature Rise

G= Voltage Drop

FUSE BLOCKS FOR 5x20mm FUSES



CQ-200P

B: 1Kg.Min.
C: AC2000V Min.
D: 6.3A250V
E: 100MΩ Min
F: 60°C Max.
G: 15mV Max.

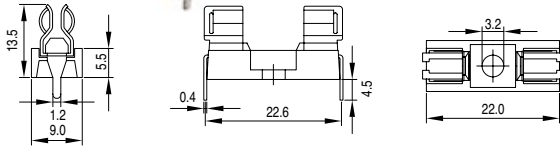

CQ-200PT

B: 1Kg.Min.
C: AC2000V Min.
D: 6.3A250V
E: 100MΩ Min
F: 60°C Max.
G: 15mV Max.

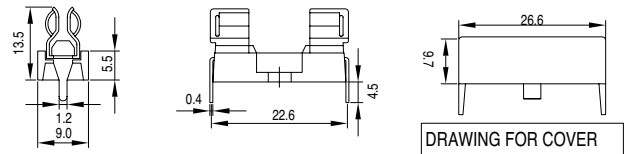

CQ-200S

B: 1Kg.Min.
C: AC500V Min.
D: 6.3A250V
E: 100MΩ Min
F: 55°C Max.
G: 20mV Max.

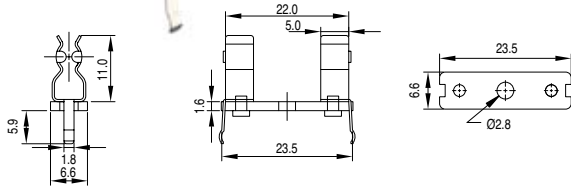

CQ-200H

B: 1Kg.Min.
C: AC500V Min.
D: 6.3A250V
E: 100MΩ Min
F: 50°C Max.
G: 20mV Max.

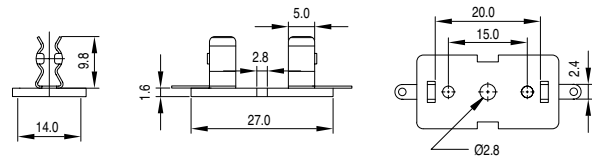

CQ-200V

B: 1Kg.Min.
C: AC500V Min.
D: 6.3A250V
E: 100MΩ Min
F: 50°C Max.
G: 20mV Max.

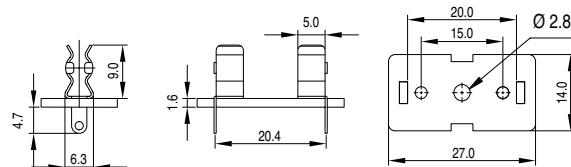

CQ-200N

B: 1.5Kg.Min.
C: AC2000V Min.
D: 15A250V
E: 500MΩ Min
F: 60°C Max.
G: 15mV Max.

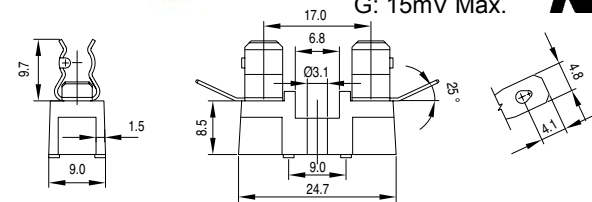

CQ-FH187

B: 1.5Kg.Min.
C: AC2000V Min.
D: 15A250V
E: 500MΩ Min
F: 60°C Max.
G: 15mV Max.

